

Step 9

Use the nylon straps to tighten the Sunbrella® top. Now it is time to adjust the bimini so that it is not crooked anymore. You can do this by moving the joining clamps (13) a bit. One person can stand in the nose of the boat and give instructions to the other person who is adjusting the camps.

Tighten all hardware for completion of bimini installation.

THE TOP SHOULD NOT BE USED WHEN VESSEL SPEED EXCEEDS 35MPH/56KPH

How to fold the Bimini

- I. Disconnect frame section (05) from the mounting bracket.
- II. Lower the frame
- III. Fold back frame section (03) and (02)
- IV. Place the cover over the folded Sunbrella® top and close the cover with the zipper.

Care and Maintenance

- I. Be sure to check and tighten all fasteners and connections prior to every use.
- II. Be cautious when driving under obstacles, low hanging structures or trees with your bimini on.
- III. Use soap and water or general cleaners to clean your bimini. Avoid abrasive materials that might scratch the bimini's finish.
- IV. Always rinse bimini after contact with salt (brackish) water.



JOBE Addict Bimini Warranty
Jobe Sports International warrants this product (not including other 3rd party accessories) against manufacturers defects. Anodizing and powder coated surfaces as well as all hardware corrosion are specifically excluded as their care and use cannot be controlled by Jobe Sports International. Any modifications or improper use shall void this warranty. Jobe Sports International is not responsible for personal injury or damage to the boat caused by the use of this tower. JOBE's obligation under this warranty shall not include any transportation charges or costs of installation or any liability for direct, indirect or consequential damages resulting from delay or improper installation. No dealer, retailer or manufacturer is the agent of Jobe Sports International and may not assume for Jobe Sports International any liability in connection with this warranty. This warranty is in lieu of all.

Distributed by:
Jobe Sports International
Heerwaardensestraat 30
6624 KK Heerwaarden
The Netherlands
WWW.JOBESPORTS.COM

JOBE ADDICT

Stainless steel

BIMINI TOP INSTALLATION GUIDE

Check WWW.JOBESPORTS.COM for other languages of this manual

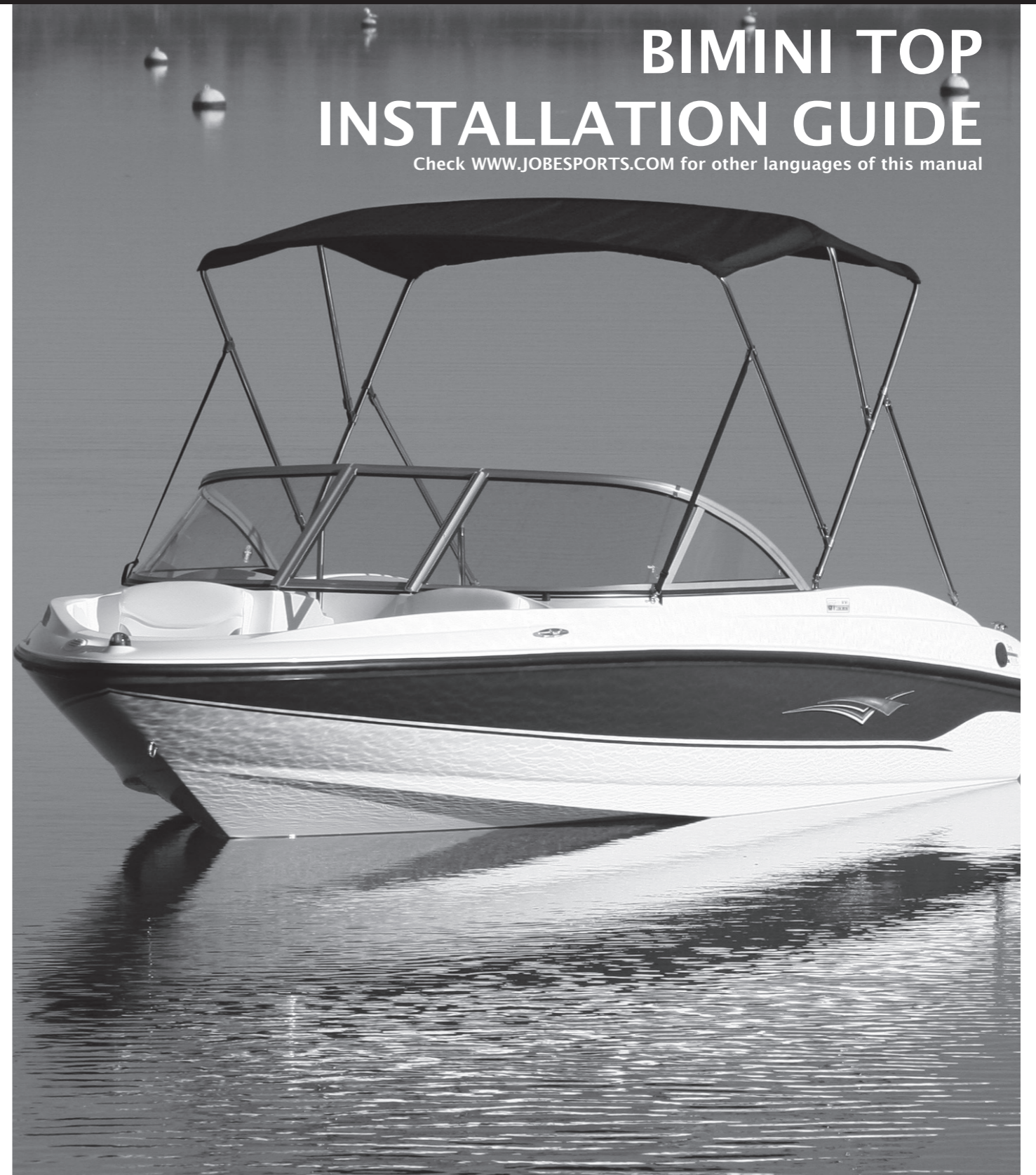

Operating under the theory that an ounce of prevention is worth a pound of headaches.
 Note that this installation guide is only a guideline. Each boat is different and improvisation is needed to mount your Addict Boat Bimini.
 We advise you to have your Bimini mounted by a professional who has experience in boat constructions and mounting towers and Biminis.
 Read and understand all of the information contained in this operator's manual before assembling and using this product.

Contents of Box

Unpack the carton, there will be 11 frame sections, mount set, Sunbrella® Top, Bimini boot and webbing straps:

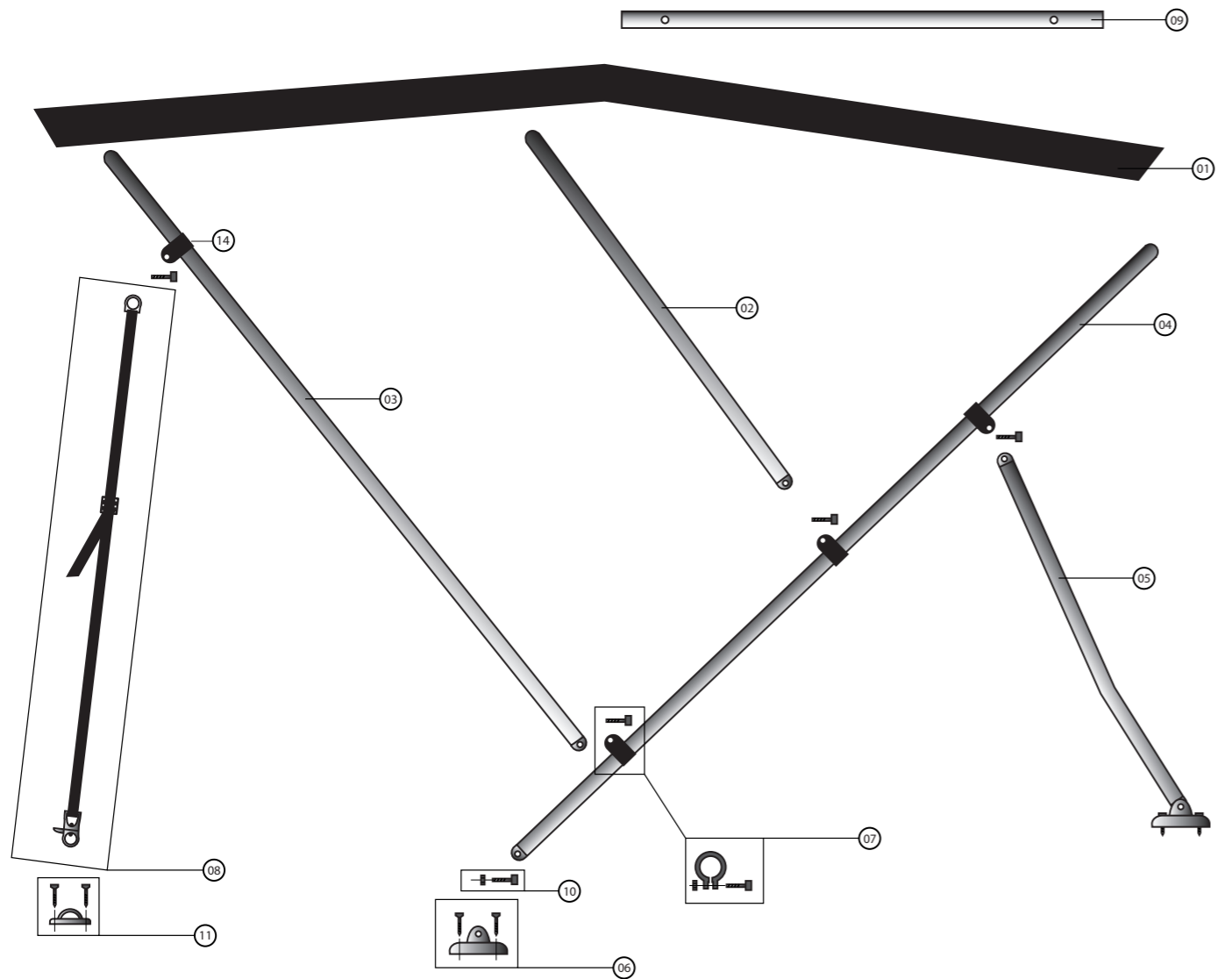

BOAT BIMINI

- BB01 Sunbrell® Top (Size S/M/L)
- BB02 Frame section (Middle)
- BB03 Frame section (Front)
- BB04 Frame section (Main)
- BB05 Support Pole
- BB06 Mounting Bracket
- BB07 Mini Clamp
- BB08 Nylon Strap
- BB09 Adjustable bar
- BB10 Connection Bolt
- BB11 Eye Strap
- BB12 Bimini Boot (storage cover)

Necessities:
 Electric Drill
 Drill bit size 4mm
 Masking tape
 Chamfer drill bit

Prior to assembly, make sure all the required parts are present.

The best way to determine the correct position on the boat is to semi-assemble the bimini and hold it over the boat with two persons so that a third person can give directions. Bear in mind the height in the boat, the windscreen window, additional tower and accessories, wiring, where the shadow should fall etc...

Step 1
 Assemble the frame as pictured below:

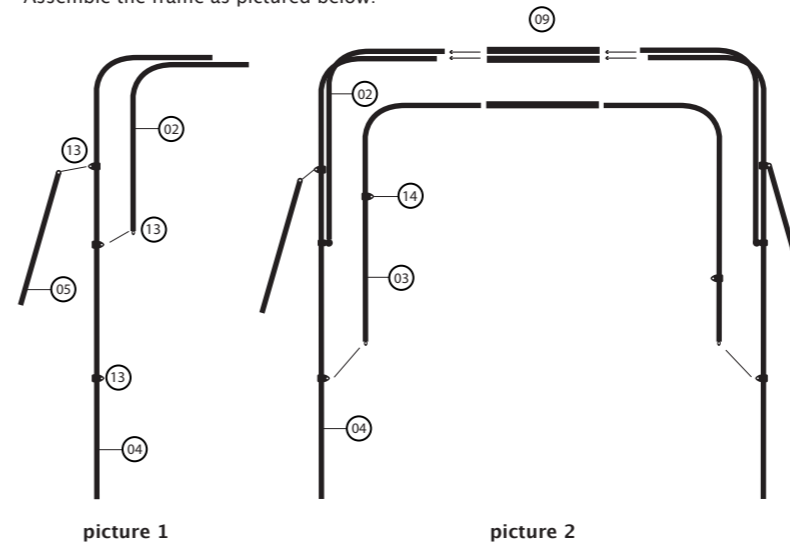

First assemble one side of the frame and slide the bimini top on the frame before assembling the other half of the frame.

The (size S) Bimini top
 67" to 72" / 170cm to 183cm

The (size M) Bimini top
 73" to 78" / 185cm to 198cm

The (size L) Bimini top
 79" to 84" / 200cm to 213cm

Assemble the bows onto one side of the legs, using the predrilled holes. Slide the large (main) bow through the sleeve on the back of the top. Slide the medium bow through the sleeve in the forward section of the bimini. Insert the last (front) bow in the sleeve of the bimini top.



Step 2
 Cover the area where the mounting feet (06) will be placed with masking tape. This should be done at all points where the bimini will contact and the near surrounding area. This will help to prevent scratches on your boat while adjusting and measuring your bimini attachment points.

Step 3
 When you have determined the correct position mark the positions of both mounting brackets (06) on one side of the boat on the masking tape using the mounting bracket. !Make sure the mounting brackets are mounted completely level (on a flat surface)!

After marking one side of the boat you can mark the other side using reference points on your boat. Make sure to mount the bracket exact on the opposite of each other.



Step 4
 Before drilling inspect underneath these locations for obstructions such as wires or cables, also check the accessibility. You are now ready to drill the holes. For this use the drill bit size 4mm.
 After drilling the holes you can remove the masking tape. It is recommended to chamfer the holes using the chamfer drill bit to prevent the gelcoat from cracking.

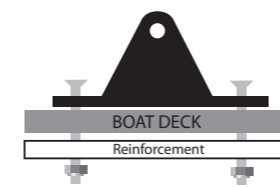

IMPORTANT: When the BOAT DECK is less than 8mm thick we strongly advise to reinforce the mounting bracket with wood or fibreglass cloth. This to prevent stress on the boat which causes the gelcoat to crack.

WARRANTY DOES NOT COVER: Any cracks or other damage to the gelcoat or boat because of mounting the bimini.



Step 5
 Supply a small amount of waterproof construction adhesive on the mounting bracket. Mount the mounting bracket on the boat with the included screws.
 (When you need to reinforce the boat deck keep in mind to use longer screws which are not included.)

Step 6
 Pick your partly assembled frame up with 2 persons and attach the front legs (04) on the mounts you have already installed on the boat. After mounting the front legs you can mount the rear legs (05)

Step 7
 Place the Sunbrella® top over the frame and zip the Sunbrella® top on the frame.
 Note to have the red Jobe label facing the front of the boat.
 Also note to fold frame section (03) to the front. this makes the assembly of the Sunbrella® top easier.



Step 8
 Attach the nylon straps on the frame (14) and determine where the eye strap should be placed. !Try to keep the nylon strap parallel to main frame section (04) and keep the strap free from any obstructions! Cover the area where the eye straps will be placed with masking tape. Mark the spot to drill the holes. Before drilling inspect underneath these locations for obstructions such as wires or cables, also check the accessibility. You are now ready to drill the holes. For this use the drill bit size 4mm. After drilling the holes, you can remove the masking tape, it is recommended to chamfer the holes using the chamfer drill bit, this to prevent the gelcoat from cracking.