

# 1&2 Piece Pod

Version 1.1 2/20/2004



## Contents of Kit

- |  |   |
|--|---|
| ① 1 or 2 piece with Bow Strap attached (1)               | ⑧ 1" OD Stainless Brace w/hole (2)          |
| ② 6' Bow Strap (1)                                       | ⑨ Deck Clevis Stud (2)                      |
| ③ Skylon Cable Protector (1)                             | ⑩ Deck Clevis Washer (Large Stainless) (2)  |
| ④ Snap Hook (1)  | ⑪ Deck Clevis Washer (Small Galvanized) (2) |
| ⑤ Quick Release Pin 1pc Pod = 1 Q-Pin/2pc Pod = 2 Q-Pins | ⑫ Deck Clevis Lock Washer (2)               |
| ⑥ 1/4"x1" Clevis Hitch Pin (6)                           | ⑬ Deck Clevis Nut (2)                       |
| ⑦ 7/8" OD Stainless Brace (2)                            | ⑭ Base Plate                                |



**Please read and understand all instructions before beginning installation.**  
**Any Questions? 800-418-1616**

## Using Your Pod

Congratulations! You have purchased a quality recreational product manufactured by Skylon. Skylon welcomes you to its growing number of customers and wishes you many happy hours of enjoyment with your new Pod. Please take time to carefully read the following operation and installation instructions along with the limited warranty governing the product before using your new Pod.

You can use your new Pod to: •**Wakeboard** •**Kneeboard** •**Barefoot Ski**

The Pod was designed to give all wakeboarders and kneeboarders... MORE AIR and LONGER AIR... and it delivers every time! But the fun doesn't stop there. Barefoot skiers have discovered that the Pod creates a "WEIGHTLESS" feel that must be experienced! This is helpful for wake cross training, learning surface tricks and improving jumping skills. Also, the upward pull that the Pod creates helps to facilitate deep water backward starts.

# 1&2 Piece Pod



## Safety

Wakeboarding, kneeboarding, barefoot skiing and waterskiing, like many other recreational pursuits, requires the exercise of caution and due care to avoid the possibility of injury. All riders should allow for a 'break-in' period so that they can adjust to the different angles of pull that the Pod creates. The Pod, because of its height and leverage, can be dangerous if it is not used properly. Proper use depends as much on the operator of the boat as it does on the rider. The following safety guidelines must be observed:

- Inspect the Pod's cable, strap and hardware before each use. Replace any damaged or worn parts with identical parts.
- Only one rider at a time should use the Pod.
- Sharp turns should be avoided while using the Pod.
- Do not use the Pod near bridges or overhead crossings.
- The rider should always wear a proper flotation device.
- Never use alcohol or drugs while using the Pod.
- Do not use top of the Pod for waterskiing. It was not designed to handle the side pulls created by hard slalom turns. However, if you wish to water ski without disassembling the Pod, simply use the Pod's built-in "Ski Eye"
- Never use the Pod to attempt 360 degree turns around the boat.
- Never allow the rider to exceed more than a 45 degree angle pull relative to the boat's line of direction. The cable support system was only designed to eliminate the extra leverage force on the Pod as depicted in the following illustration.
- Do not use the Pod for towing inflatables or parachutes.

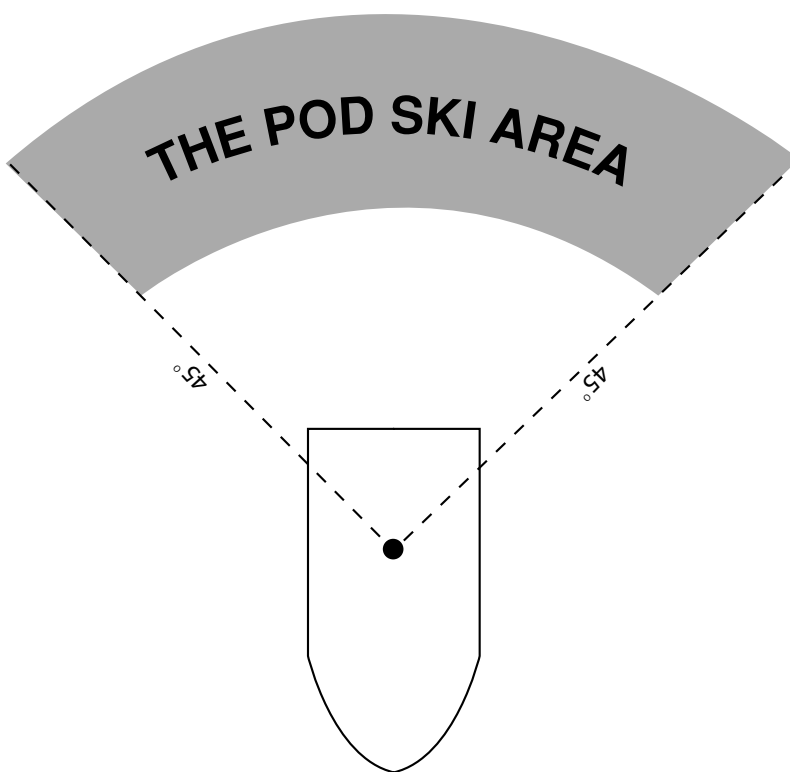

# 1&2 Piece Pod



## Parts List

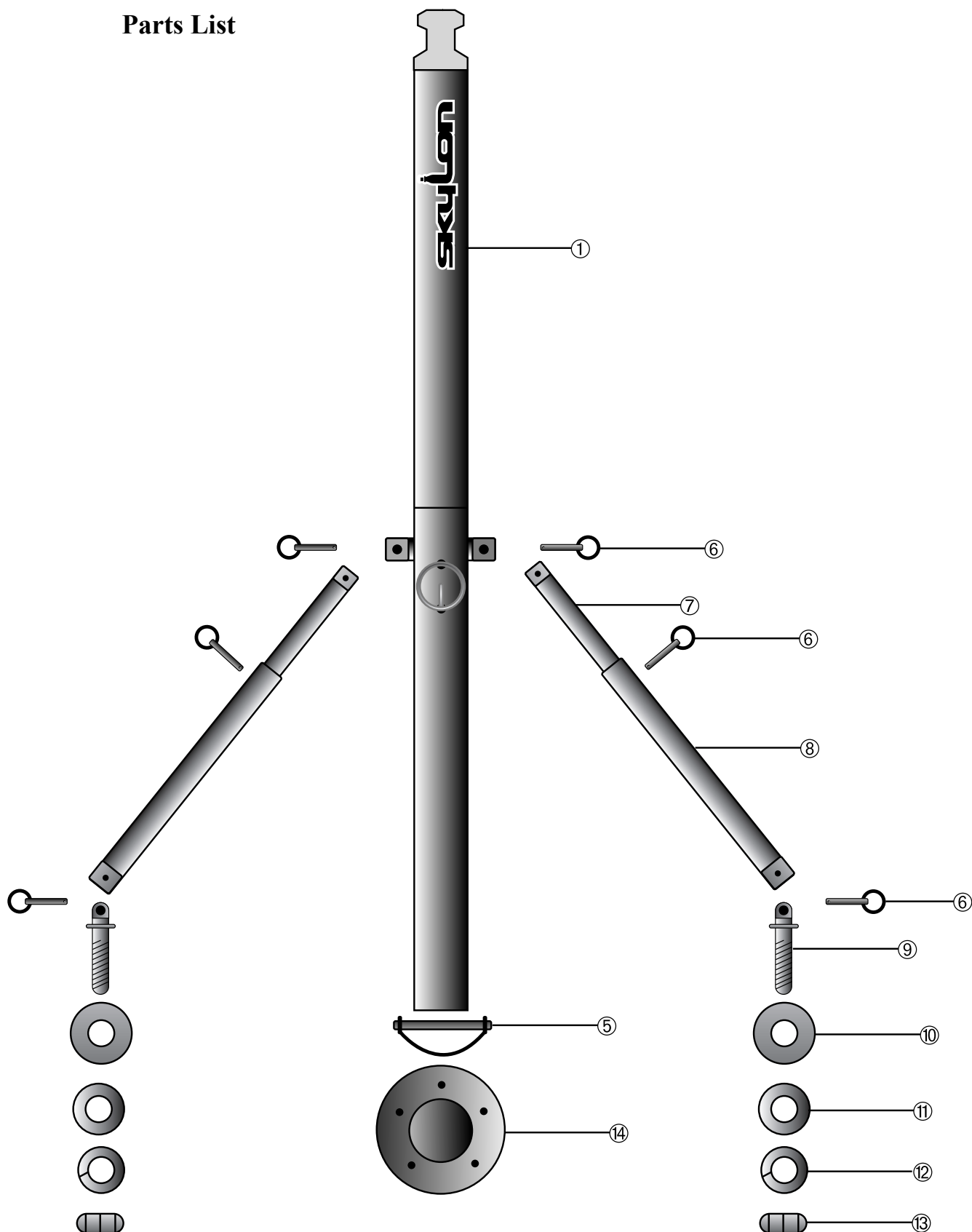

# 1&2 Piece Pod



## Installation Instructions

Installation of “The Pod” by Skylon is quite simple. It is designed to fit on most I/O and outboard boats. It is important that you read and familiarize yourself with these instructions before beginning installation.

- ① Identify all parts and hardware. If anything is missing call Skylon (800) 418-1616 or e-mail [rob@skylonsports.com](mailto:rob@skylonsports.com) for replacement parts.
- ② Attach the base plate (#14) to the bottom of the Pod with quick release pin (#5).
- ③ Position the Pod and attached base plate on the center line of your boat. The center line runs from the center of the bow to the center of the stern. Choose a location on the center line that makes the most sense for your interior configuration.
- ④ Secure the base plate to the bottom of the boat with 1/4-20 SS bolts (not supplied). If access to the bottom is not possible, use 5/16” SS Lag screws and seal the holes with silicone to prevent moisture from entering the holes.
- ⑤ Extend the attached telescoping support arms towards the back of the boat and outward to the gunnels to a position approximately 45 to 60 degrees from the Pod. This is also the recommended pulling area behind your boat. Braces too close together will allow the Pod to be pulled over when towing a wakeboarder or skier outside the recommended brace area.
- ⑥ Mark the spots for the deck clevis stud (#9) by placing the large SS Washer (#10) on a flat surface on the top rear sides or corners of your gunnels. Once you have the washer in place, mark the center of the holes with a marker. After both sides have been marked, make sure they are in the same position on each side and you can access the bottom side of each gunnel with a washer (#11) lock washer (#12) and nut (#13) before drilling.
- ⑦ On the marked locations predrill the holes with a 1/8” bit followed by a 5/8” bit.
- ⑧ Preassemble the deck clevis (#9) with the large stainless washer (#10). Push the clevis assembly through the drilled hole. Place the small galvanized washer (#11) lock washer (#12) and nut (#13) on the threaded side of the deck clevis and tighten firmly. Note: if the deck is not 1/2” thick at the drilled holes, you will need to add a block of plywood or similar material to the bottom side of gunnels to distribute the load.
- ⑨ Attach the braces to the deck clevis stud by connecting them with the 1/4”x1” hitch pin’s (#6). With forward pressure to the Pod. Drill a 1/4” hole through the predrilled pilot holes of each larger brace (#8). Once drilled insert the 1/4”x1” hitch pins (#6).
- ⑩ Pull the 6ft Bow Strap (not shown in parts list) through your boat’s Bow Eye. Center the 6ft Bow Strap so that it cradles up and around each side of your boat’s rub rails.
- ⑪ Using the Snap Hook (not shown in parts list), attach each side of the 6ft Bow Strap to the Black Ratchet Strap.
- ⑫ Once attached, pull all the slack out of the Black Ratchet Strap until it is tight. Then, using the Ratchet, continue to tighten the ratchet strap until the desired ‘preload’ is achieved.
- ⑬ Slide down the Pod Cable Protector until it is over the Black Ratchet Strap. Once positioned, pull the Plastic Zip Tie to secure the fit.

You can easily disassemble the Pod by sliding the Cable Protector up the White Cable and then releasing the Ratchet. This will loosen all straps, which will allow the 6ft Bow strap to be unhooked. Release the 2- 1/4”x1” hitch pins and Q-pin and your Pod can be stored.

# 1&2 Piece Pod



Figure 1 – Side View

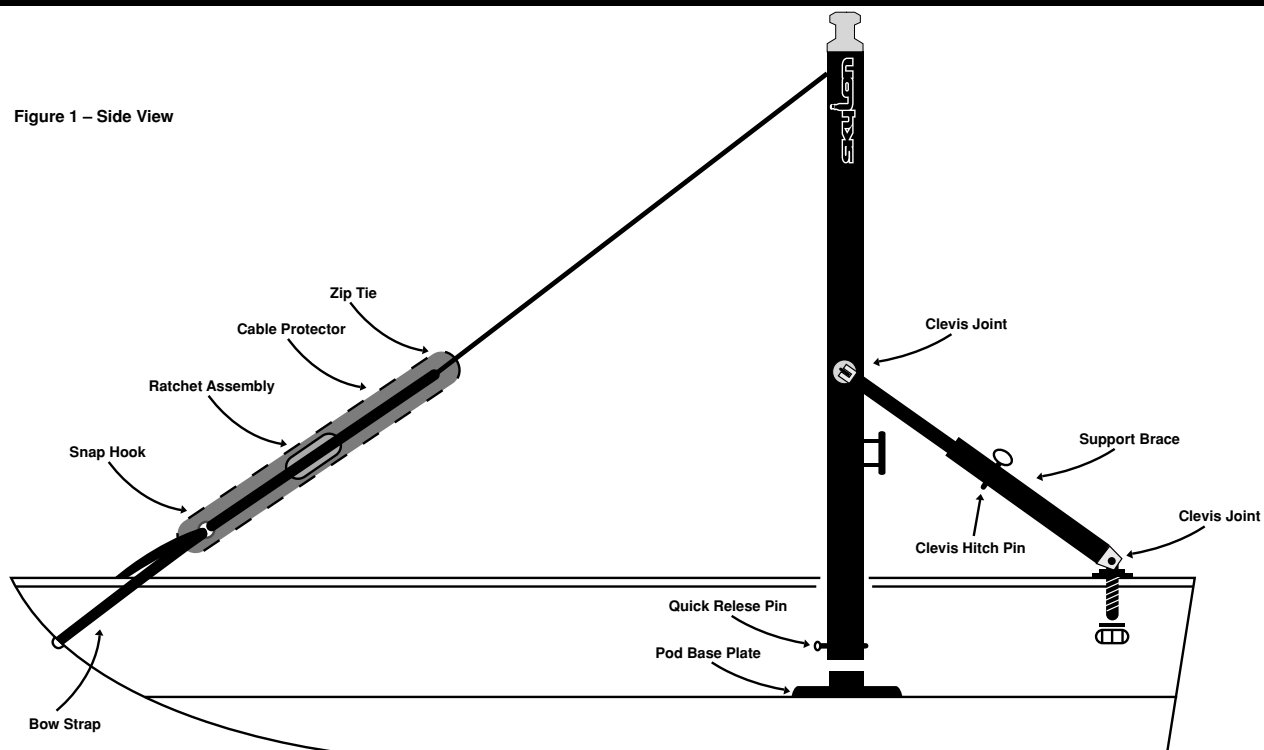
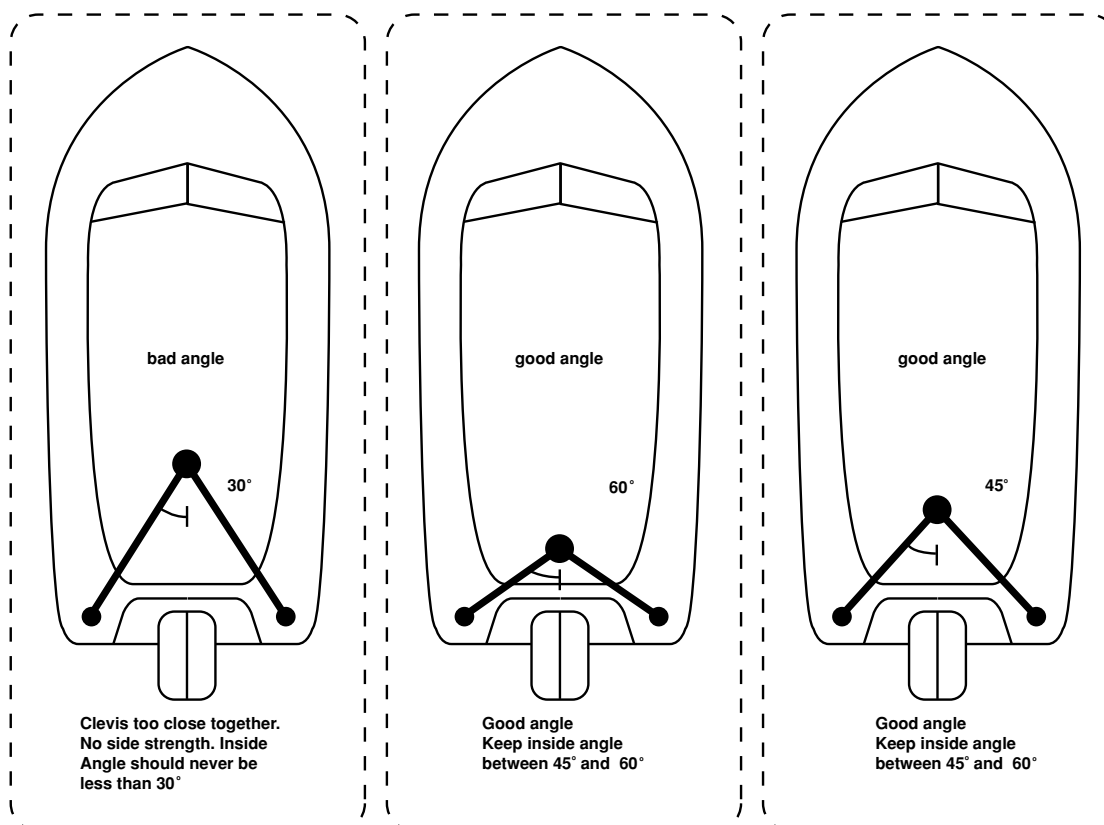

Figure 2 – Top View



# 1&2 Piece Pod



## Limited Warranty

Skylon warrants to the original consumer purchaser that this product shall be free of defects in material and workmanship for a period of one (1) year from the purchase date.

This LIMITED WARRANTY shall not cover or extend to any products or components manufactured by Skylon:

- That have failed as a result of the misuse, abuse or improper maintenance of said product or component.
- That have been repaired or altered by any person or entity other than Skylon or its authorized distributors.
- That have been damaged by accident, fire, negligence or other casualty not attributable to the manufacturer.
- That have not been operated in accordance with the printed operating and safety instructions of the manufacturer.

This LIMITED WARRANTY shall also exclude any products or components not manufactured by Skylon and, as to such product or component, only the warranty, if any, of the original manufacturer shall apply. This warranty shall not operate to extend the duration of the warranty of the original manufacturer for any such product or component.

Skylon will repair or replace a manufactured product without cost to the purchaser if same is defective in material or workmanship.

THIS LIMITED WARRANTY OF SKYLON IS THE FULL AND COMPLETE WARRANTY APPLICABLE TO THE SUBJECT, PRODUCT OR COMPONENT. THIS LIMITED WARRANTY EXCLUDES THE IMPLIED WARRANTY OF FITNESS PURSUANT TO SECTION 316 OF THE UNIVERSAL COMMERCIAL CODE. THERE ARE NO WARRANTIES WHICH EXTEND BEYOND THE DESCRIPTION ON THE FACE HEREOF. THIS LIMITED WARRANTY CONSTITUTES THE FULL EXTENT OF ANY RESPONSIBILITY OF SKYLON TO THE ORIGINAL PURCHASER OF THE PRODUCT OR COMPONENT.

LIMITED ON LIABILITY: SKYLON WILL NOT BE LIABLE FOR ANY INCIDENTAL OR CONSEQUENTIAL DAMAGES RESULTING DIRECTLY OR INDIRECTLY FROM THE FAILURE OF THE SUBJECT, PRODUCT OR COMPONENT.

This LIMITED WARRANTY is being issued in lieu of any other representation by word or conduct whether expressed or implied.

Skylon  
224 Malbert Street  
Perris, CA 92570  
(800) 418-1616