

RIGID INFLATABLE BOAT

SILVER LINE

MODELS:

S550LF, S550CF, S550RF

USER'S MANUAL

SILVER LINE S550

GRAND" inflatable motor boat of the "SILVER LINE" series: S550 has been designed under requirements of ISO 6185 "Plastomer and Elastomer Inflatable Boats" и DIN 7870 "Inflatable Boats with Reinforced Shells".

The rigid inflatable motor boat of the "SILVER LINE" series relates to the category of pleasure boats and is intended for water sports, tourism and rest.

TECHNICAL DATA SPECIFICATION

| Model | Unit | S550LF/S550RF/S550RF |
|------------------------------------|-----------|----------------------|
| Length overall | m | 5.4 |
| | ft-inches | 17'9" |
| Length inside | m | 4.15 |
| | ft-inches | 13'7" |
| Width overall | m | 2.55 |
| | ft-inches | 8'4" |
| Width inside | m | 1.45 |
| | ft-inches | 4'9" |
| Tube diameter max | m | 0.55 |
| | ft-inches | 22" |
| Passenger capacity | pers. | 10 |
| Number of chambers | | 5 |
| Load capacity | kg | 1200 |
| | lbs | 2640 |
| Boat weight | kg | 540 |
| | lbc | 1188 |
| Engine power recommended | H.P | 115 |
| | kW | 84.6 |
| Engine power max | H.P | 120 |
| | kW | 88.3 |
| Engine weight max | kg | 240 |
| Engine shaft length | | L(long) |
| Boat design Category(Dir.94/25/EC) | | C |

SILVER LINE S550

COMPLETE SET

| Model | S550LF | S55CF | S550RF |
|--|--------------------------|--------------------------|--------------------------|
| STANDART FEATURES | | | |
| Heavy-duty Deep-V handlaid polyester hull | <input type="checkbox"/> | <input type="checkbox"/> | <input type="checkbox"/> |
| Molded in bow locker with access door and soft cushion | <input type="checkbox"/> | <input type="checkbox"/> | <input type="checkbox"/> |
| Rear locker with access door, soft seat and seat back | <input type="checkbox"/> | <input type="checkbox"/> | <input type="checkbox"/> |
| Fiberglass step ends for inflatable tube | <input type="checkbox"/> | <input type="checkbox"/> | <input type="checkbox"/> |
| Steering console with front seat, windshield and railing | <input type="checkbox"/> | <input type="checkbox"/> | <input type="checkbox"/> |
| Mechanical steering system with steering wheel and cable | <input type="checkbox"/> | <input type="checkbox"/> | <input type="checkbox"/> |
| SD-05 standing bar with 2 lockers | <input type="checkbox"/> | <input type="checkbox"/> | <input type="checkbox"/> |
| 2 swivel capitan chairs with pedestals | <input type="checkbox"/> | <input type="checkbox"/> | <input type="checkbox"/> |
| Front storage locker with hatch, lifters and soft cushion | <input type="checkbox"/> | <input type="checkbox"/> | <input type="checkbox"/> |
| Stainless steel navigation arch with handrails | <input type="checkbox"/> | <input type="checkbox"/> | <input type="checkbox"/> |
| Polyester navigation arch | <input type="checkbox"/> | <input type="checkbox"/> | <input type="checkbox"/> |
| 2 rear pull up stainless steel cleats | <input type="checkbox"/> | <input type="checkbox"/> | <input type="checkbox"/> |
| Bow step plate with anchor roller, 2 fairleads and pull-up-cleat | <input type="checkbox"/> | <input type="checkbox"/> | <input type="checkbox"/> |
| Build-in 90-lit. fuel tank with filler and send | <input type="checkbox"/> | <input type="checkbox"/> | <input type="checkbox"/> |
| 2 paddles and footpump | <input type="checkbox"/> | <input type="checkbox"/> | <input type="checkbox"/> |
| User's manual | <input type="checkbox"/> | <input type="checkbox"/> | <input type="checkbox"/> |
| GRAND LUXE FEATURES | | | |
| Electric packages | <input type="checkbox"/> | <input type="checkbox"/> | <input type="checkbox"/> |
| Boat cable | <input type="checkbox"/> | <input type="checkbox"/> | <input type="checkbox"/> |
| Stainless steel bow railing and 2 rear handrails | <input type="checkbox"/> | <input type="checkbox"/> | <input type="checkbox"/> |
| Two swim platforms with handles | <input type="checkbox"/> | <input type="checkbox"/> | <input type="checkbox"/> |
| Boarding ladder | | | |

SILVER LINE S550

COMPLETE SET

| Model | S550LF | S550CF | S550RF |
|--|--------------------------|--------------------------|--------------------------|
| OPTIONAL EQUIPMENT | | | |
| Keel and tubeprotection system | <input type="checkbox"/> | <input type="checkbox"/> | <input type="checkbox"/> |
| Overall cover | <input type="checkbox"/> | <input type="checkbox"/> | <input type="checkbox"/> |
| Console cover | <input type="checkbox"/> | <input type="checkbox"/> | <input type="checkbox"/> |
| Upgrade to close-cell foam cushions set | <input type="checkbox"/> | <input type="checkbox"/> | <input type="checkbox"/> |
| Bimini-top and filding st. steel ladder | <input type="checkbox"/> | <input type="checkbox"/> | <input type="checkbox"/> |
| Tachometer, speedometer, compass | <input type="checkbox"/> | <input type="checkbox"/> | <input type="checkbox"/> |
| Removable bow sundeck with cushions | <input type="checkbox"/> | <input type="checkbox"/> | <input type="checkbox"/> |
| Water shower set with 50-lit. tank, pump, shower | <input type="checkbox"/> | <input type="checkbox"/> | <input type="checkbox"/> |
| Hydraulic steering system with steering wheel | <input type="checkbox"/> | <input type="checkbox"/> | <input type="checkbox"/> |

S550RF

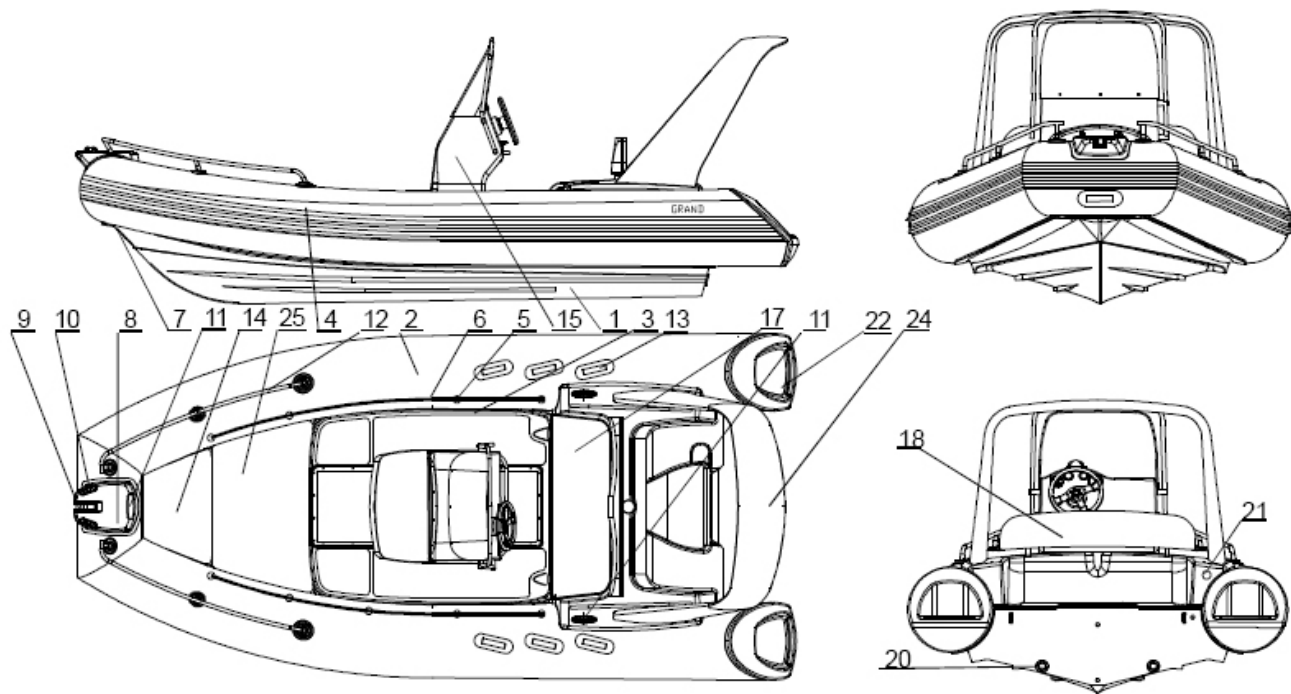

S550CF

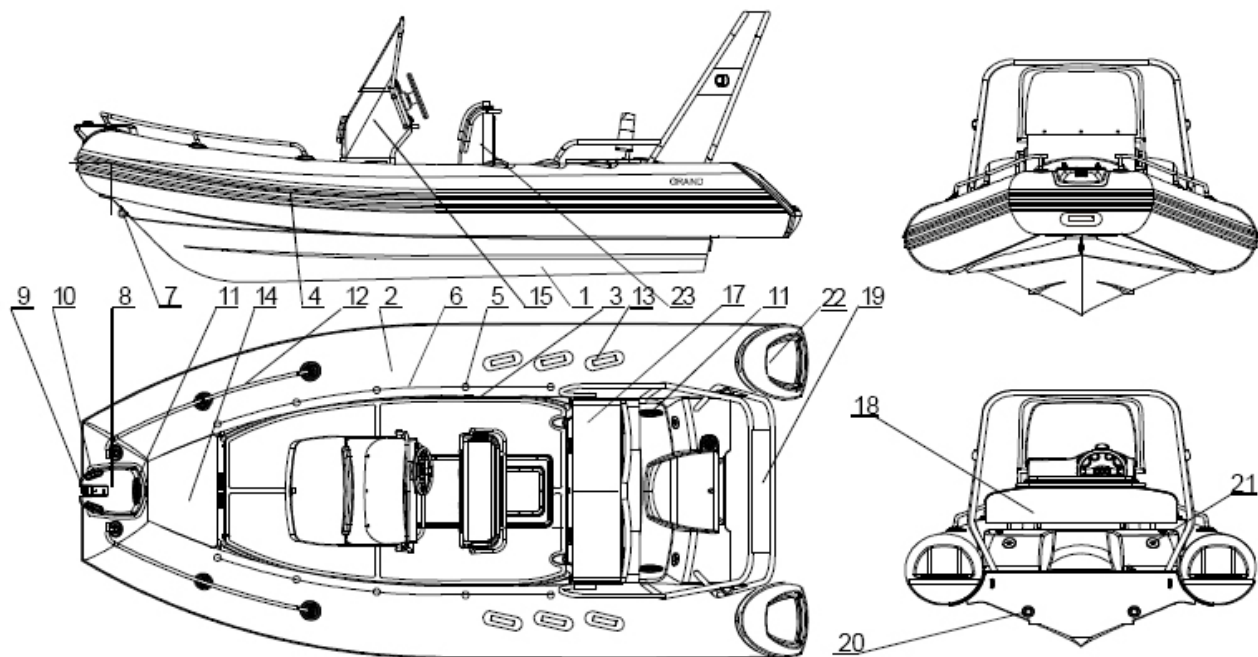

S550LF

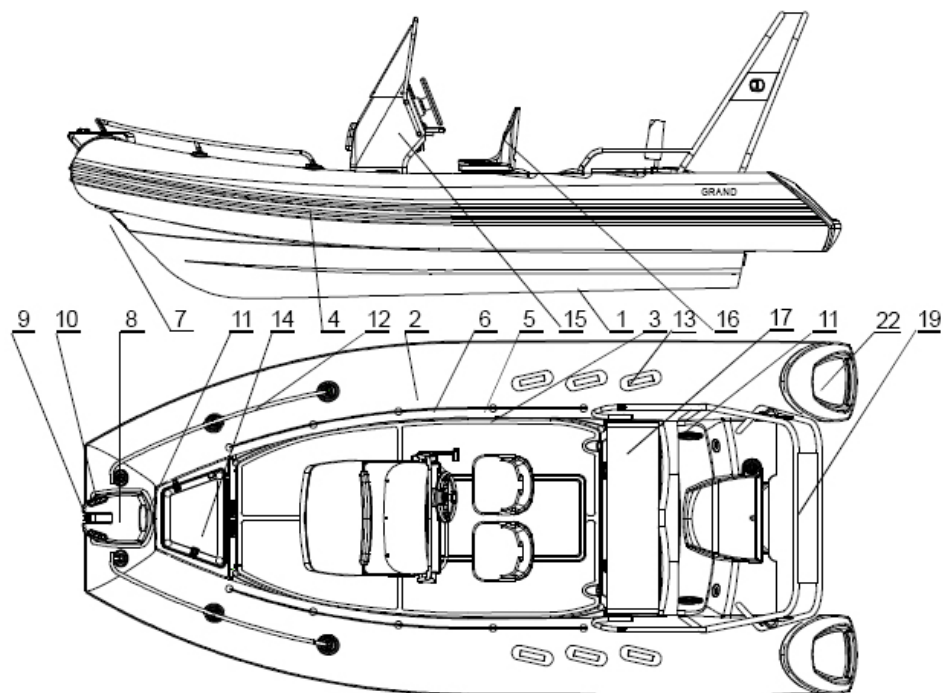

SILVER LINE S550

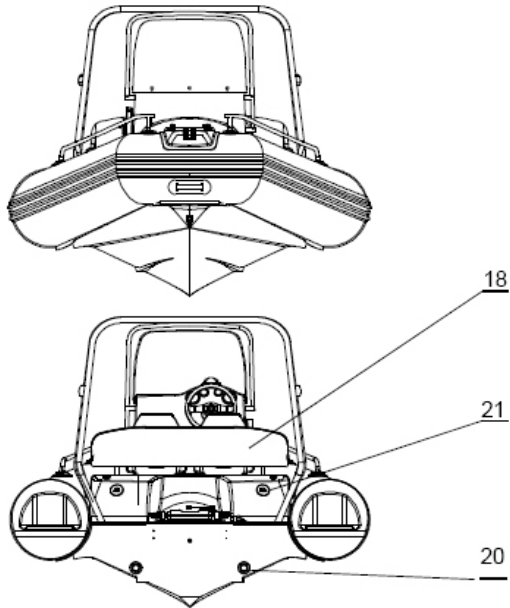

| Pos | Item |
|-----|-------------------------------------|
| 1 | Fiberglass hull |
| 2 | Rainforced buoyancy tube |
| 3 | Inflation / deflation valve |
| 4 | Doubled rubbing strake |
| 5 | Lifeline holder |
| 6 | Internal lifeline |
| 7 | Towing bow eye |
| 8 | Bow step-plate with antiskid layer |
| 9 | Anchor roller |
| 10 | Continental fairlead |
| 11 | Pull-up cleat |
| 12 | Stainless steel bow railing |
| 13 | Safety handle |
| 14 | Bow locker with access hatch |
| 15 | Steering console with front stowage |
| 16 | Adjustable pilot chear |
| 17 | Stern locker seating |
| 18 | Stern seating soft back |
| 19 | Stainless steel arch |
| 20 | Cockpit drain system socket (2pcs.) |
| 21 | Filler |
| 22 | Fiberglass step ends |
| 23 | SD-05 standing bar |
| 24 | Polyester navigation arch |
| 25 | Front storage locker |

INFLATION / DEFLATION VALVES OPERATION

The inflation/deflation valve is intended for:

- filling the compartment with air from a standart pump or filling system and maintaining pressure in the tube for prolonged time.
- adjustable drop of pressure in compartment.

The air fill valve is designed as a tab-type non-return valve.

Every inflation / deflation valve includes the following parts : valve body 1, valve nut 5, valve cap 2 with strap 3, washerwith gasket 4, spindel 6 with spring 7, cup diaphragm 8 (Fig.1).

INFLATION MODE : valve is closed with gasket 4 tight . To move the valve to deflation mode : push the button 6 and turn it clockwise to fix it in lower position

DEFLATION MODE : button is fixed in lower position. To move the valve to inflation mode : push the button 6 and turn it counter clockwise. The button goes to upper position.

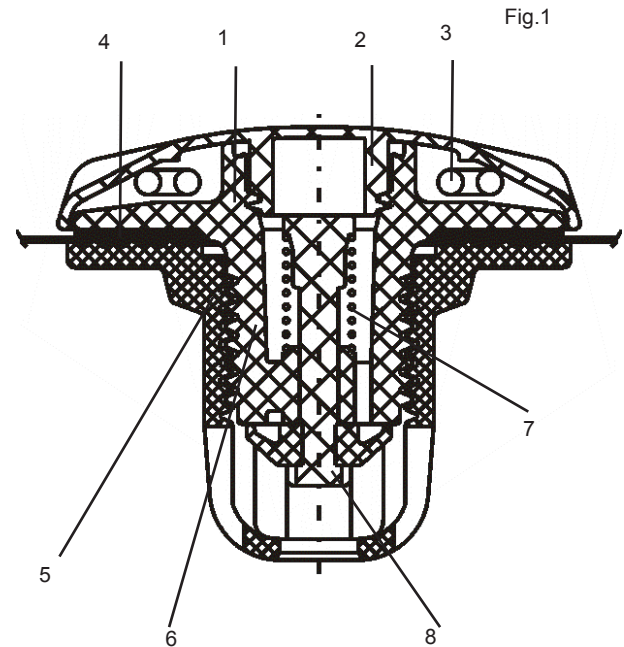

ATTENTION !

1. *Overinflating of your boat, when the air pressure is more than nominal, sufficiently decreases the boat life time.*
2. *The valves are airtight just in case they are closed with the caps tight.*
3. *The tube is airtight in case it keeps its form for 8 hours at least.*

SILVER LINE S550

PREPARATION FOR EXPLOITATION

In order to set the boat in operation condition perform as follows:

- unfold the inflatable tube;
- mount outboard engine on the transom in accordance with its own installation instruction.
- extend engine remote control cables and steering cable from engine mounting place to steering console mounting place through holes on the deck and helm stowage.

STEERING CONSOLE INSTALLATION

In order to install the steering console, perform the next operations (Fig. 2, Fig. 5):

- hinge out the steering console overhead;
- open the front seating;
- open hatch of the console back locker;
- extend steering cable and engine remote control cables through hole in the steering console bottom;
- align console bottom holes with holes in the deck surfaces and fix console to deck by means of bolts M8x30, serrated lock washers and washers from complete set;
- attach steering cable to the steering mechanism and install engine remote control block to the overhead console;
- connect electric cable to the steering console (see wiring diagram);
- double-check that the steering and remote control cables have been connected correctly. For checking refer to the steering mechanism and engine instructions manual;

- fix the overhead console part by means of washers, serrated lock washers and nuts;
- close front seating and hatch of the locker.

ATTENTION ! To avoid water penetration into the console inner layers, please, tight all hole free space with any water resistant filler.

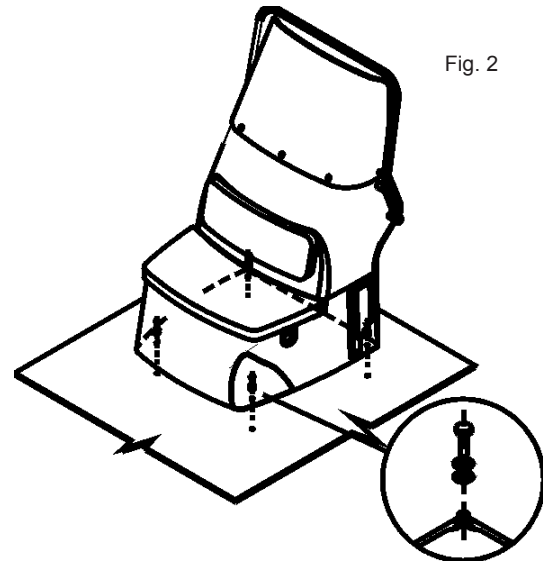
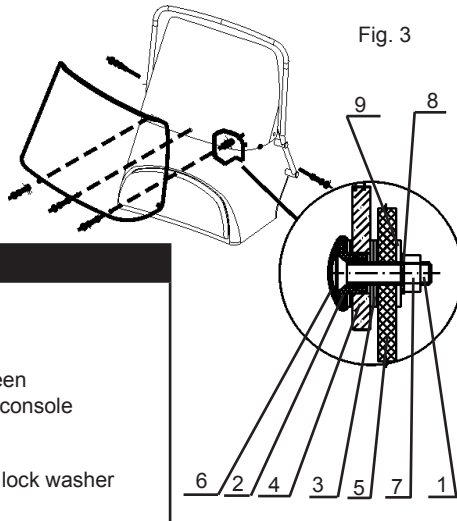

Fig. 2

SILVER LINE S550

In order to install the windscreen onto console perform the next operations (Fig. 3):

- align the windscreen holes with holes on console overhead part;
- fix windscreen by means of screws M6x25, bushs 1, bushs2, serrated lock washers, washers and nuts M6 from the complete set;
- tighten all nuts.



In order to install the windscreen railing onto console perform the next operations (Fig. 4):

- align holes in the windscreen railing supports with holes on console overhead part;
- fix windscreen railing by means of bolts M12x30, serrated lock washers and washers from the complete set;
- tighten all bolts.

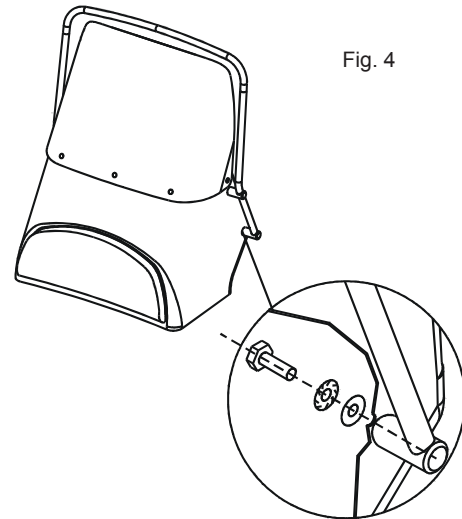

PILOT SEAT INSTALATION

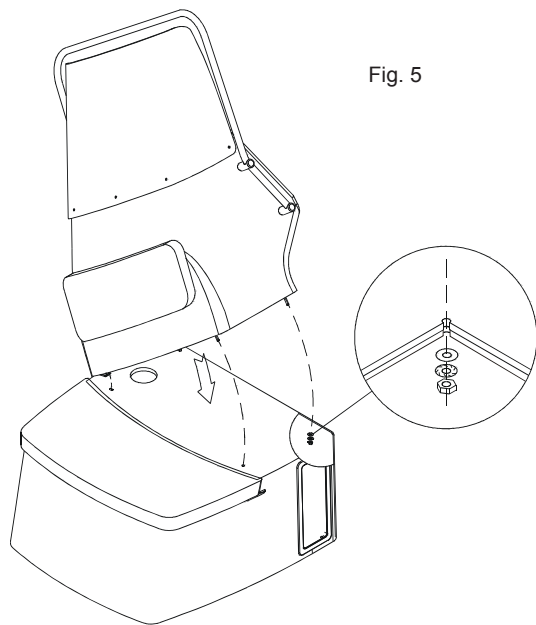

In order to install pilot seat onto deck perform the next operations (Fig. 6):

- align bottom pilot seat holes with holes on the deck;
- fix pilot seat by means of screws M6x25,
- tighten all screws;

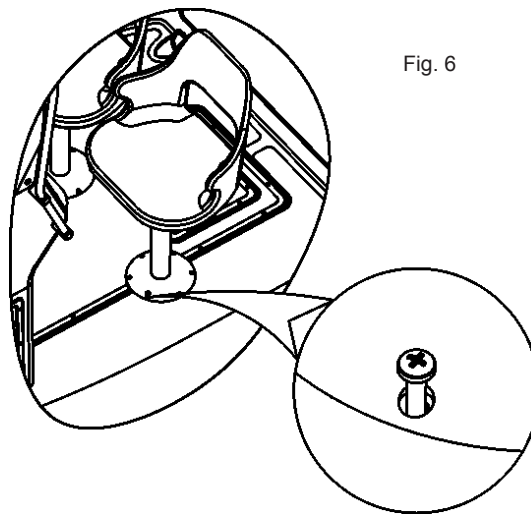

STERN SOFT SEAT-BACK MOUNTING

In order to install the stern locker seat-back, perform the next operations (Fig.7)

- hinge out the seat of stern locker;
- insert seat-back support into the holes of stern surface;
- fix seat-back by means of the bolts M8x50, shaped washers, washers and arrester nuts M8 from the complete set;
- tighten all the bolts;
- replace the locker seat.

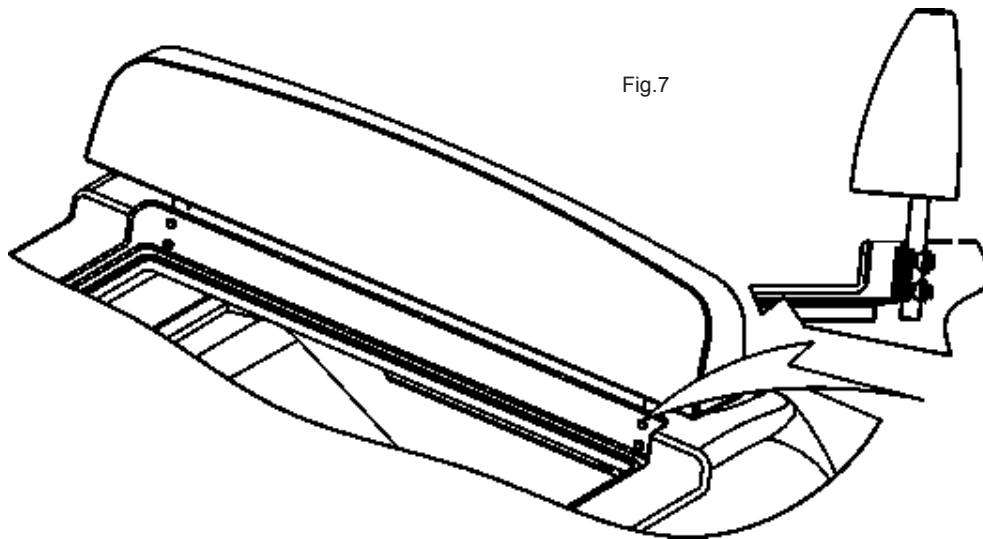

Fig.7

SILVER LINE S550

ARC MOUNTING

In order to install the stainless steel arc, perform the next operations (Fig.8):

- hinge out the seat of stern locker;
- insert arc stud in the stern surface holes ;
- fix arc by means of the nuts M12 and bolts M12, M8, serrated lock washers and washers from the complete set ;
- tighten all nuts and bolts;
- replace the locker seat.

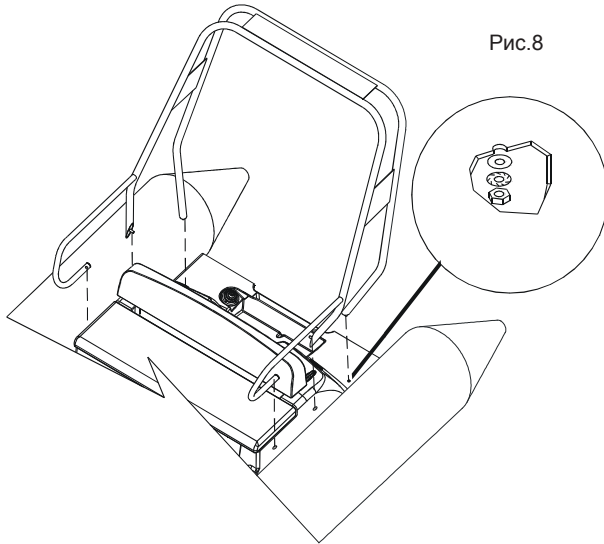

In order to install the stainless steel arc, perform the next operations (Fig.8a):

- hinge out the seat of stern locker;
- insert arc stud in the stern surface holes ;
- fix arc by means of the nuts M12, serrated lock washers and washers from the complete set ;
- tighten all nuts in order to install the stainless steel arc, perform the next operations (Fig.8):

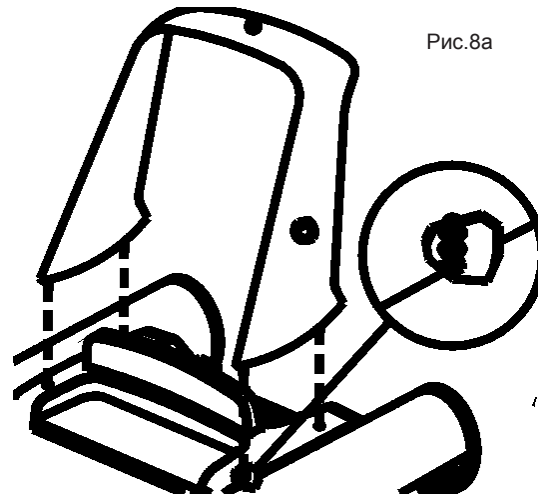

SILVER LINE S550

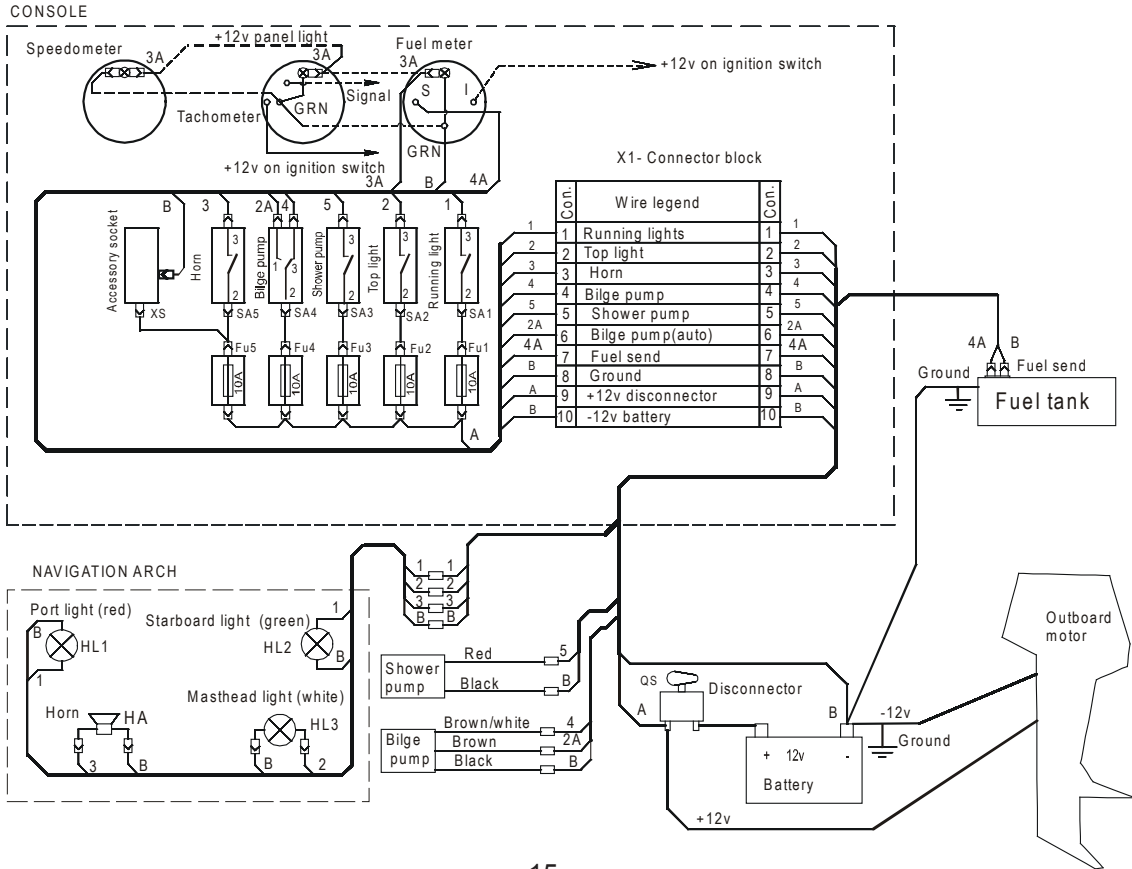

MAINTENANCE

Main conditions of long service life is right and careful service.

Avoid excessive increasing of pressure in the board, especially from heating by the sun rays.

After exploitation take off sand and dirt from boat surface, and carefully dry it.

Avoid the water getting into the chambers. If a fuel or an oil / gas gets to the boat surface it is necessary to wash the soiling place by soap water as soon as possible and dry.

Pay attention to the condition of bottom and seat surfaces. If the coating is destroyed it is necessary to dry this element and restore the defend ply.

After the season prepare the boat to winter keeping. Clean boat surface from sand and dirt and make the necessary repairs, if damages take place. If it is possible, keep the boat in the open and slightly pumped state in air temperature 0-25°C. The boat must be protected from the sun rays.

Insignificant boat repairing (eliminating the board punctures or cuts) you may carry out by yourself. In this case use the coated fabric patches from the complete set. Ask your dealer for the correct type of glue you may use for the repair.

In case if sufficient damages of hull, tube body, partitions or seams it is recommended to apply for professional repair in authorised service station.

OPERATING REGULATIONS

Dear user,

We thank you for your purchase and do hope that you will have a great fun of it. However, to make your joy and pleasure complete, we would request you to read carefully and observe the directions and recommendations specified below.

IT IS STRICTLY FORBIDDEN :

to handle the boat in the state of intoxication and without individual rescue means being used (life-saving belts, jackets, etc.)

IT IS FORBIDDEN :

- to overload the boat above the design weight-carrying capacity;
- to use an outboard engine of power exceeding the maximum allowable value;
- to bring the tube pressure up to the value exceeding the rated one (0.15 bar/ 2.15 psi);
- to drag the boat across a rough surface.

Danger of usage of engine having insufficient or excessive power

According to the safety regulations, each inflatable boat should be furnished with an outboard engine having the maximum allowable power. You will find the data on the maximum allowable power of the engine on the manufacturer's plate with the designation of the model type inscribed thereon. The plate is fixed in the afterbody of the boat. However, you should choose the engine power within the allowable range so as to ensure that you may safely reach the shore when heading into the wind or into the current.

Observation of local shipping regulations

For each particular water area the local shipping regulations are in force. You may apply for information to the appropriate water transport and shipping directorate, as well as to the water police.

Proper usage of boat equipment and accessories

Use the boat equipment and accessories only on their direct purpose to ensure reliable service.

Availability of Oars

Even when sailing with an outboard engine you should always have the oars available with you so that you were able to reach the shore without outside assistance in case of any damage to the boat.

Usage of emergency stop switch

On your request any outboard engine seller may provide your engine with the emergency stop switch. During navigation the switch should be connected to the wrist of your hand by means of a cord. In case you fall overboard, even if being a steersman, the switch will cut out the engine and the propeller. This arrangement will enable you to avoid any traumas and to reach the boat.

Prevention of damages caused by electrolyte or fuel leakages

Take all possible precautions against penetration of fuel or electrolyte from the storage battery into the inflatable boat. If it does happen wash thoroughly the fouled spots with water.

Cargo arrangement and stowing, attachment of items and prevention of falling overboard

You should be always sure that the number of people on board never exceeds that specified in the user's manual or on the manufacturer's plate provided on the transom.

The boat will retain an adequate floatability and will not keel over only provided that the load is arranged reasonably. Therefore, do not accommodate all passengers on the same side of the boat. Arrange the cargo to be carried uniformly inside the boat, all items being reliable secured on the bottom of the boat. All passengers should be accommodated inside the boat.

The occupied seats should not be left throughout the entire sail time. When sailing with an outboard engine the steersman should shift his body forward in the course of acceleration to prevent the boat forebody from raising under the force of upthrust waves.

Presence of sharp and pricking objects on board

Despite the strong shell of the boat we are recommended to handle sharp and pricking objects being on board with care. For example, it concerns a knife blade, fish-hook point, etc.

Rocky shore, mole, shoals (for example, sand banks, coral reefs, rocks)

Approach rocky shores, shoals, moles, etc. carefully to avoid damages to the boat. It is strictly prohibited to drag the boat across rough surfaces (shingle, rocks, concrete, etc.).

Check at navigation

In case of prolonged navigation with the use of an outboard engine, regularly check to ensure that the engine is reliably attached to the boat. If the engine was attached carelessly the attachment may work loose under the action of vibration.

Besides, check air chambers pressure at regular intervals, since the pressure may vary under the effects of outside air temperature and atmospheric pressure variations.

Never forget to monitor regularly the quantity of fuel in the fuel tank. Keep always in mind that the quantity of fuel should be sufficient for you to sail to your final destination.

Availability of rescue means (life-saving jackets, distress signals, spare parts)

If you are planning to go beyond the protected water areas you should provide all passengers on board with life-saving jackets under strong wind and heavy seaways conditions. Those passengers who cannot swim should always carry the life-saving jackets while on board! It is also recommended to keep constantly distress signal means on board.

Towing

At towing the towing rope length should not be at least 3 lengths of the boat, the rope being secured to both boats in a manner ensuring its immediately, single-motion release. The steersman of the towed boat should be assisted by another crew member to monitor the process of towing. In this case, certain communication gestures should be agreed upon beforehand.

Damage to one of air chambers

The inflatable boat is designed to provide an adequate stability in case of the complete damage to one the air chambers (balloon compartments) at the expense of the remaining air chambers and the hull. Thanks to it, you will be able to reach safely the nearest shore. Reduce the speed and shift your body to the undamaged part of the boat. Watch changes in stability. After this immediately head for the nearest shore. To prevent penetration of water into the boat, pull the shell of the damaged air chambers upwards.

Anchor and mooring fast fastening

Fix the anchor and towing ropes in the forebody of the boat to the front towing ring. Fix the back spring on the transom via special holes.

Danger of currents and wind

Before navigation of the boat in unfamiliar waters make detail inquiries about local conditions and regulations! Currents, wind, shoals, rising and falling tides, as well as weather variations may imply serious danger!

In emergency stay in boat

In any unexpected situation (engine failure, boat damage, etc.) do not ever leave the boat provided it is still afloat. Even if you believe that the shore is just nearby stay in the boat, since you will be looked for in this particular place and, most probably, will be found. Should the boat become partially flooded throw heavy objects (batteries, fuel tank, engine) overboard to ensure additional floatability.

The “GRAND” Company employees would like to wish you a pleasant and safe leisure time!